

# CCDNI-700DS-19

515L Double Door Fridge

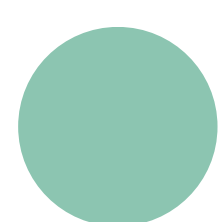

## Key Features



Inverter  
Compressor

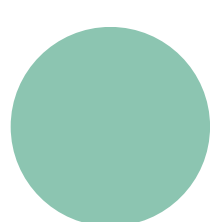

Total No Frost

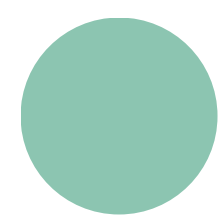

Multi Air Flow

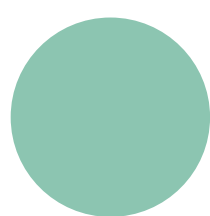

Height: 1.68m

## Specifications

Total Net Capacity: 515L  
Dimensions(mm): H1680 x W750 x D785  
Inverter Compressor  
Multi Air Flow  
External Control Panel  
Door Alarm / Door Lock  
LED Lighting

### Fridge Compartment: 386L

Glass Shelf X2  
Door Rack x3  
Chriller x1  
Crisper x2  
Egg Tray X1 Butter Rack x1  
Freezer: 129L  
Glass Shelf X1  
Door Rack x2  
Ice Maker x1

Refrigerant: R600a

Color: Silver

Country of Origin: China

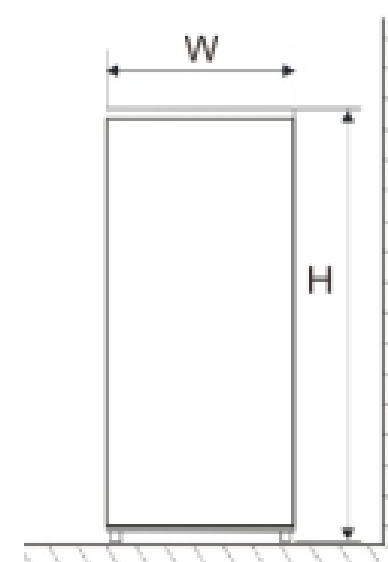

Fig. 1

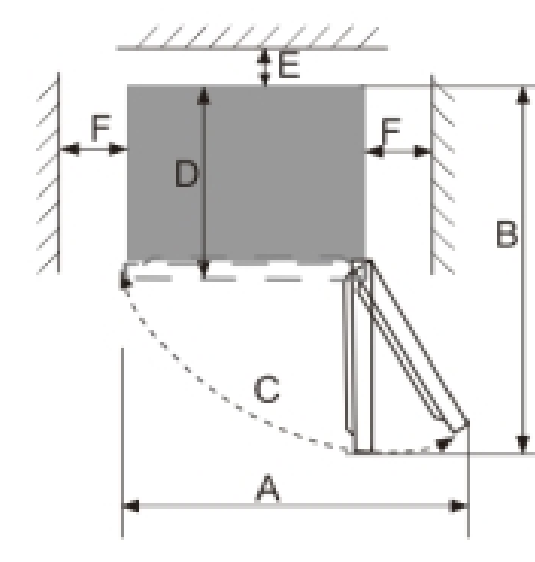

Fig. 2

W	D	H	A
750	785	1680	1280
B	C(°)	E	F
1490	130±5	50	100

Design & Specifications are subject to change without prior notice